



**Department of
Transportation**

KATHY HOCHUL
Governor

MARIE THERESE DOMINGUEZ
Commissioner

BRIAN KELLY, P.E.
Regional Director

August 15, 2023

Town of Hornellsville Clerk
Ms. Jessica LaFrance
4 Park Ave. P.O. Box 1
Arkport NY 14807

RE: Regulations of off-premise signs located along State Routes

Dear Sir or Madam:

The New York State Department of Transportation is required by the Federal Highway Administration (86 & 88 Highway Law & agreements with the Federal Government), in accordance with the Highway Beautification Law, to conduct an annual sign surveillance of certain roads that are eligible for federal aid. As the result of our annual sign surveillance, we must send several removal notices to the owner of every illegal sign found. This includes signs meant to be seen along certain State Routes, whether in the right-of-way or on private property.

Please refer any of your residents who would like to place an advertising sign that will be visible from State Routes to me at (607) 324-8572 or Laura.Lowe@dot.ny.gov.

If it appears that they will qualify for a permit, we will send them an application. With the completed application, we require that they send written confirmation from the municipality stating that a building permit either can be issued or that one is not required to ensure that the sign will meet all local regulations.

We are sending this notice annually to all of the municipalities within our region that include any roads we control signing along. Please share this information with your Zoning/Code Enforcement Officers or any other personnel that it may apply to.

Thank you in advance for your cooperation. More information can be found at www.dot.ny.gov/programs/nys-signs. Please contact me at (607)324-8572 or Laura.Lowe@dot.ny.gov if you have any questions.

Sincerely,

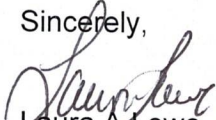
Laura A. Lowe, RES 1
Property Management Unit
Office of Right of Way
LAL/la

Steuben County Controlled Routes

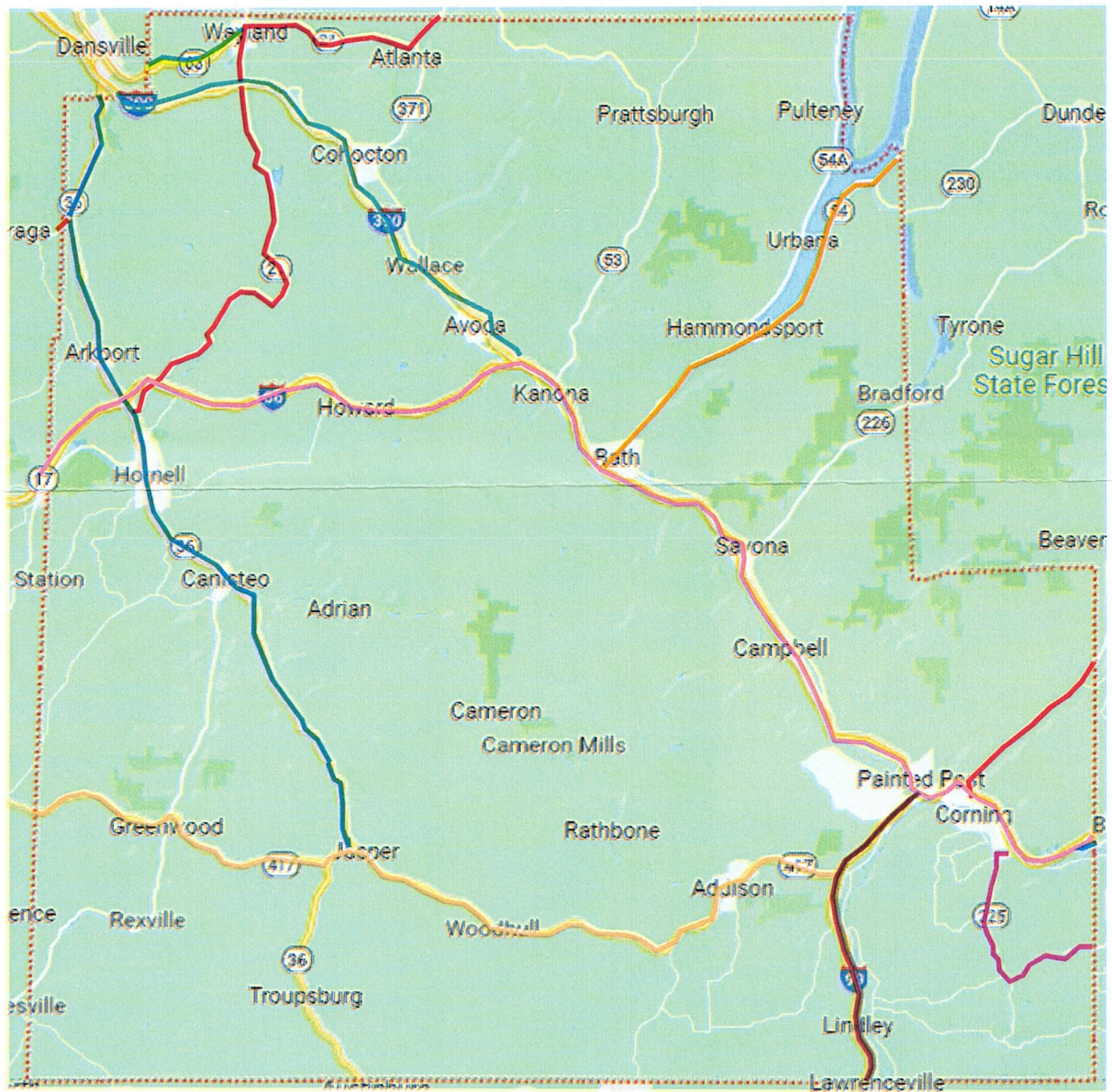

- State Route 21— from 36/21 intersection in Hornell, north to border of Ontario County
- State Route 36— from border of Livingston County, south to intersection of 36/417 (near Jasper)
- State Route 54— from Bath north to border of Yates County
- State Route 63— from 63/21 intersection west to border of Livingston County
- State Route 70a— from intersection of 36/70a to border of Allegany County
- State Route 352— from intersection of 352/225 to border of Chemung County
- State Route 414 - from Corning north to border of Chemung County
- State Route 417— from border of Allegany County east to intersection with I-99
- State Route 960— off of I-86 west, around bridge into Corning (East Corning Road bridge)
- I-86— from border of Allegany County east to Chemung County
- I-390— from intersection of I-86/I-390 north to border of Livingston County
- State Route 961T— I-86 Exit 48 connector to State Route 352 near South Corning
- State Route 961Q— I-86 Exit 47 connector to State Route 352 approximately 2 miles west of Big Flats
- I-99— from Pennsylvania border north to Painted Post